

OPERATING INSTRUCTIONS

Ambic QMI™ Quarter Milk Isolator



Features

The QMI™ Quarter Milk Isolator is designed to isolate the milk of one quarter from the other three during milking. It is a useful device for managing milk quality, in cases where elevated somatic cell counts (SCC) are observed in one quarter. Isolating the milk from a high SCC quarter by using the QMI™ Quarter Milk Isolator, can significantly lower the SCC in the bulk milk tank which can help yield higher milk premiums.

- Large 2 US gallon (7.5L) capacity.
- Large 4" (100mm) opening for ease of emptying and cleaning.
- Heavy duty stainless steel bail holds lid in place.
- 90 degree elbow allows easy connection of liner/inflation and facilitates good liner/inflation presentation for clean milk out.
- Large bore, flexible silicone rubber hoses make connection and manipulation easy.



OPERATING INSTRUCTIONS

Ambic QMI™ Quarter Milk Isolator



Features

The QMI™ Quarter Milk Isolator is designed to isolate the milk of one quarter from the other three during milking. It is a useful device for managing milk quality, in cases where elevated somatic cell counts (SCC) are observed in one quarter. Isolating the milk from a high SCC quarter by using the QMI™ Quarter Milk Isolator, can significantly lower the SCC in the bulk milk tank which can help yield higher milk premiums.

- Large 2 US gallon (7.5L) capacity.
- Large 4" (100mm) opening for ease of emptying and cleaning.
- Heavy duty stainless steel bail holds lid in place.
- 90 degree elbow allows easy connection of liner/inflation and facilitates good liner/inflation presentation for clean milk out.
- Large bore, flexible silicone rubber hoses make connection and manipulation easy.



Assembly

Quarter Milk Isolator, complete AQM/001 (1/2" OD Elbow) AQM/001-14 (14mm OD Elbow)

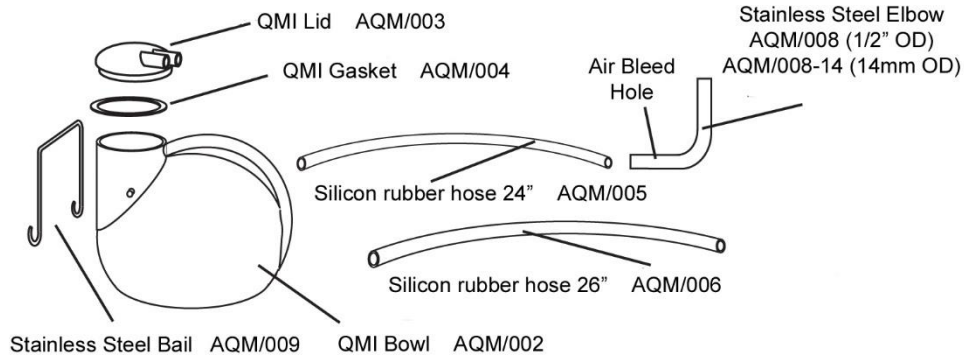

1. Attach the two silicone rubber hoses to the nozzles on the lid.
2. Attach the stainless steel elbow to the other end of the 24" silicone rubber hose. For best operation, push the elbow end with the small air bleed hole into the silicone tubing. Do not cover the air bleed hole with the hose.
3. Make sure the gasket is in place on the lid. Place the lid and hose assembly onto the bowl.
4. Secure the lid in place by lifting the bail up and over the centre of the lid so that it locates in the small recess in the centre of the lid to create a good seal.

Operation

After assembling the QMI™ Quarter Milk Isolator as described above, you are ready to use the device.

1. The best location for the QMI™ Quarter Milk Isolator is in a safe place as close to the cow's udder as possible.
2. Remove the inflation/liner from the claw that corresponds to the quarter which has a suspected high SCC.
3. Attach the inflation/liner to the stainless steel elbow on the QMI.
4. Place the other QMI hose onto the open claw nipple. Milk the cow as normal. The high SCC milk will be deposited into the QMI™ Quarter Milk Isolator while the milk from the other three healthy quarters goes to the bulk tank.
5. Push the bail off the lid and empty the bowl.
6. Rinse the inflation/liner and the QMI™ Quarter Milk Isolator with water, sanitize it with chlorine or iodine and replace it onto the claw.

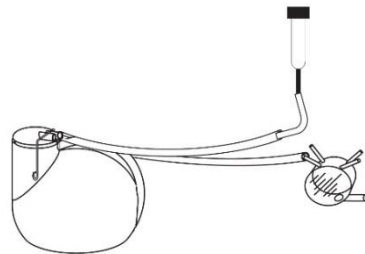

Ambic Equipment Limited, 1 Parkside, Avenue Two Station Lane, Witney,
Oxfordshire, OX28 4YF, England
Tel: +44 (0) 1993 776555 Fax: +44 (0) 1993 779039 sales@ambic.co.uk

Assembly

Quarter Milk Isolator, complete AQM/001 (1/2" OD Elbow) AQM/001-14 (14mm OD Elbow)

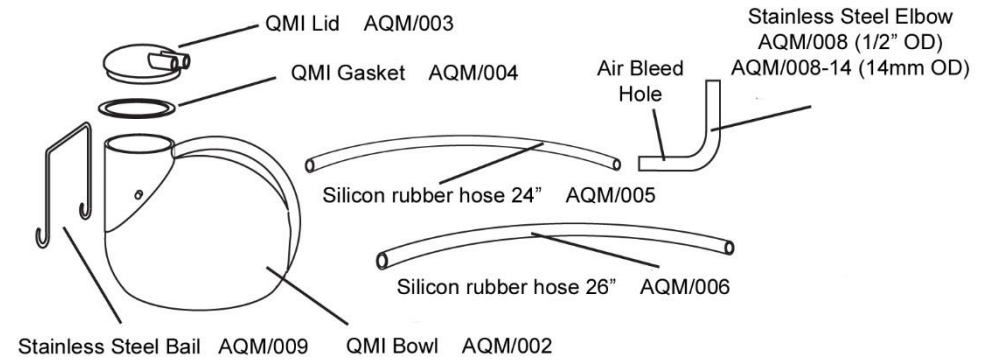

1. Attach the two silicone rubber hoses to the nozzles on the lid.
2. Attach the stainless steel elbow to the other end of the 24" silicone rubber hose. For best operation, push the elbow end with the small air bleed hole into the silicone tubing. Do not cover the air bleed hole with the hose.
3. Make sure the gasket is in place on the lid. Place the lid and hose assembly onto the bowl.
4. Secure the lid in place by lifting the bail up and over the centre of the lid so that it locates in the small recess in the centre of the lid to create a good seal.

Operation

After assembling the QMI™ Quarter Milk Isolator as described above, you are ready to use the device.

1. The best location for the QMI™ Quarter Milk Isolator is in a safe place as close to the cow's udder as possible.
2. Remove the inflation/liner from the claw that corresponds to the quarter which has a suspected high SCC.
3. Attach the inflation/liner to the stainless steel elbow on the QMI.
4. Place the other QMI hose onto the open claw nipple. Milk the cow as normal. The high SCC milk will be deposited into the QMI™ Quarter Milk Isolator while the milk from the other three healthy quarters goes to the bulk tank.
5. Push the bail off the lid and empty the bowl.
6. Rinse the inflation/liner and the QMI™ Quarter Milk Isolator with water, sanitize it with chlorine or iodine and replace it onto the claw.

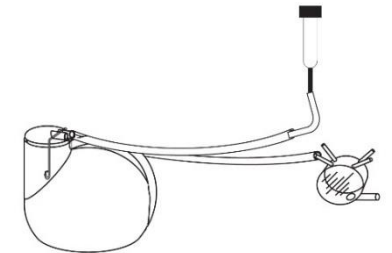

Ambic Equipment Limited, 1 Parkside, Avenue Two Station Lane, Witney,
Oxfordshire, OX28 4YF, England
Tel: +44 (0) 1993 776555 Fax: +44 (0) 1993 779039 sales@ambic.co.uk